



CITY OF STOCKTON

PUBLIC WORKS DEPARTMENT

22 East Weber Avenue, Room 301 • Stockton, CA 95202-2317 • 209/937-8411 • Fax 209/937-8277
www.stocktongov.com

LETTER OF CLARIFICATION NO. 1

POLICE HEADQUARTERS WOMEN'S LOCKER ROOM REMODEL PROJECT NO. P015035-A

TO ALL PROSPECTIVE BIDDERS

DATE: February 28, 2022

Letter of Clarification No. 1 for the above project consists of the following:

1. This acknowledgement form (see important notice at the end of this form).
2. Requests for clarification shall be submitted by 2:00 p.m. on Thursday, February 24, 2022. If a request warrants a letter of clarification and sufficient time exists to prepare one, such letter of clarification will be posted on Bid Flash at least two days prior to bid opening.

SPECIFICATIONS

1. Section 00 01 10 Table of Contents – **Add** section 07 16 16 Crystalline Waterproofing.
2. Section 07 16 16 Crystalline Waterproofing – **Add** this section in its entirety. Waterproofing required under alternate at Toilet 4 along existing concrete wall.

PLANS

1. Sheet A-101 Enlarged Demo Floor Plans - **Remove** this sheet in its entirety and **Replace** with the attached sheet of the same name. Changes are marked by cloud with delta 1. Relocation of lockers revised from 2nd floor to adjacent Property Vault 46 room. Preparation and repair of concrete wall added to Toilet 4 alternate work. Also refer to Specification item 1 under this letter of clarification.
2. Sheet A-102 Enlarged New Floor Plans - **Remove** this sheet in its entirety and **Replace** with the attached sheet of the same name. Changes are marked by cloud with delta 1. Move back of lockers revised from 2nd floor to adjacent Property Vault



Letter of Clarification No. 1
Police Headquarters Women's Locker Room Remodel, Project No. P015035-A
February 28, 2022
Page 2

46 room. Waterproofing of concrete wall added to Toilet 4 alternate work. Also refer to Specification item 1 under this letter of clarification.

JODI ALMASSY, DIRECTOR
PUBLIC WORKS DEPARTMENT

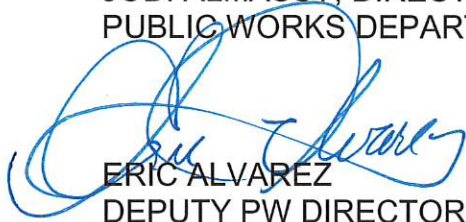

ERIC ALVAREZ
DEPUTY PW DIRECTOR/CITY ENGINEER

JLA:EA:WJ:RD:JL:RB:cal

NOTICE: THIS FORM MUST BE SIGNED AND RETURNED WITH YOUR BID. FAILURE TO INCLUDE OR ACKNOWLEDGE A CLARIFICATION MAY RESULT IN THE BID BEING REJECTED AS NOT RESPONSIVE.

CONTRACTOR: _____

BIDDER SIGNATURE: _____

DATE: _____

Stockton Police HQ Women's Locker Room Remodel

**SECTION 07 16 16
CRYSTALLINE WATERPROOFING**

PART 1 GENERAL**1.01 SECTION INCLUDES**

- A. Crystalline waterproofing.
- B. Preparation of surfaces to be waterproofed, including plugging active water leaks.

1.02 RELATED REQUIREMENTS

- A. Section 03 30 00 - Cast-in-Place Concrete: Concrete work to be waterproofed.

1.03 REFERENCE STANDARDS

- A. COE CRD-C 48 - Method of Test for Water Permeability of Concrete 1992.
- B. NRCA (WM) - The NRCA Waterproofing Manual 2005.

1.04 SUBMITTALS

- A. See Section 01 30 00 - Administrative Requirements, for submittal procedures.
- B. Product Data: Manufacturer's data sheets on each product to be used, including:
 - 1. Test data showing hydraulic permeability.
 - 2. Preparation instructions and recommendations.
 - 3. Storage and handling requirements and recommendations.
 - 4. Installation methods.
 - 5. Details for waterproofing at joints, intersections, and other special conditions.
- C. Specimen warranty.

1.05 QUALITY ASSURANCE

- A. Manufacturer Qualifications: Company specializing in manufacture of products of the type specified.

1.06 DELIVERY, STORAGE, AND HANDLING

- A. Store products in manufacturer's unopened packaging until ready for installation.
- B. Take necessary precautions to keep cementitious materials dry.

1.07 FIELD CONDITIONS

- A. Maintain environmental conditions (temperature, humidity, and ventilation) within limits recommended by manufacturer for optimum results; do not install products under environmental conditions outside manufacturer's absolute limits.

1.08 WARRANTY

- A. See Section 01 78 00 - Closeout Submittals, for additional warranty requirements.
- B. Provide installer's warranty agreeing to correct leaking waterproofing for two years from Date of Substantial Completion, unless leakage is caused by structural failure, movement of the structure, or other causes beyond the installer's control.

PART 2 PRODUCTS**2.01 MANUFACTURERS**

- A. Crystalline Waterproofing:
 - 1. Xypex Chemical Corporation; XYPEX Concentrate: www.xypex.com/#sle.
 - 2. Euclid Chemical Company; VANDEX SUPER: www.euclidchemical.com/#sle.
 - 3. Kryton International Inc; Krystol T1 Concrete Waterproofing: www.kryton.com/#sle.
 - 4. W.R. Meadows, Inc; CEM-KOTE CW PLUS: www.wrmeadows.com/#sle.
 - 5. Substitutions: See Section 01 60 00 - Product Requirements.

2.02 APPLICATIONS

- A. Crystalline Waterproofing for Building Surfaces:
 - 1. Negative (interior side) of footings and foundation walls.

Stockton Police HQ Women's Locker Room Remodel

2. Surfaces as indicated on drawings.

2.03 MATERIALS

- A. Crystalline Waterproofing: Portland cement, quartz or silica sand, and other active chemicals that when applied to surface of concrete forms insoluble crystals in capillary pores preventing passage of liquids, while having no adverse effect on normal properties of concrete.
 1. Hydraulic Permeability of Applied Concrete: No measurable leakage or water flow at pressure ranging from 175 psi (1.21 MPa) to 200 psi (1.38 MPa) when tested in accordance with COE CRD-C 48, using at least 2 inch (51 mm) thick sample, and with applied surface preparation and installation in accordance with NRCA (WM).
 2. Toxicity: Non-toxic.
 3. Color: Gray.

PART 3 EXECUTION**3.01 EXAMINATION**

- A. Do not begin installation until substrates have been properly prepared.
- B. If substrate preparation is the responsibility of another installer, notify Architect of unsatisfactory preparation before proceeding.

3.02 PREPARATION

- A. Clean surfaces thoroughly prior to installation.
- B. Prepare surfaces using methods recommended by manufacturer for achieving best result for substrate under project conditions, and use sand blasting, water blasting, or acid etching as recommended.
- C. Plug water leaks.
- D. Patch holes, construction joints, and cracks; remove defective concrete.
- E. Obtain approval of manufacturer's field representative before beginning installation.

3.03 INSTALLATION

- A. Install in strict accordance with manufacturer's instructions, maintain environmental conditions required and recommended by manufacturer, and keep a copy of manufacturer's instructions on site.
- B. Coordinate installation with installation of products that must penetrate waterproofed surfaces.
- C. Prevent excessive drying of surface.
 1. Cure waterproofing for at least three days, or length of time required by manufacturer, with water spray and adequate air circulation.
 2. Do not use chemical curing agents unless explicitly approved by waterproofing manufacturer.
- D. Do not backfill, fill water or liquid holding structures, or apply finish coatings until time period recommended by manufacturer has passed.

3.04 FIELD QUALITY CONTROL

- A. See Section 01 40 00 - Quality Requirements, for additional requirements.
- B. Flood test waterproofing application by filling water holding structures to capacity and allowing to stand for not less than 24 hours.
- C. If any leaks appear, notify Architect and drain.
 1. Repair leaks at no additional cost to City.
 2. Repeat flood test until any leakage is eliminated.

3.05 PROTECTION

- A. Protect from damage by weather; do not cover with impermeable (plastic) sheeting unless air circulation is provided.

Stockton Police HQ Women's Locker Room Remodel

B. Touch-up, repair or replace damaged waterproofing after Date of Substantial Completion.

END OF SECTION

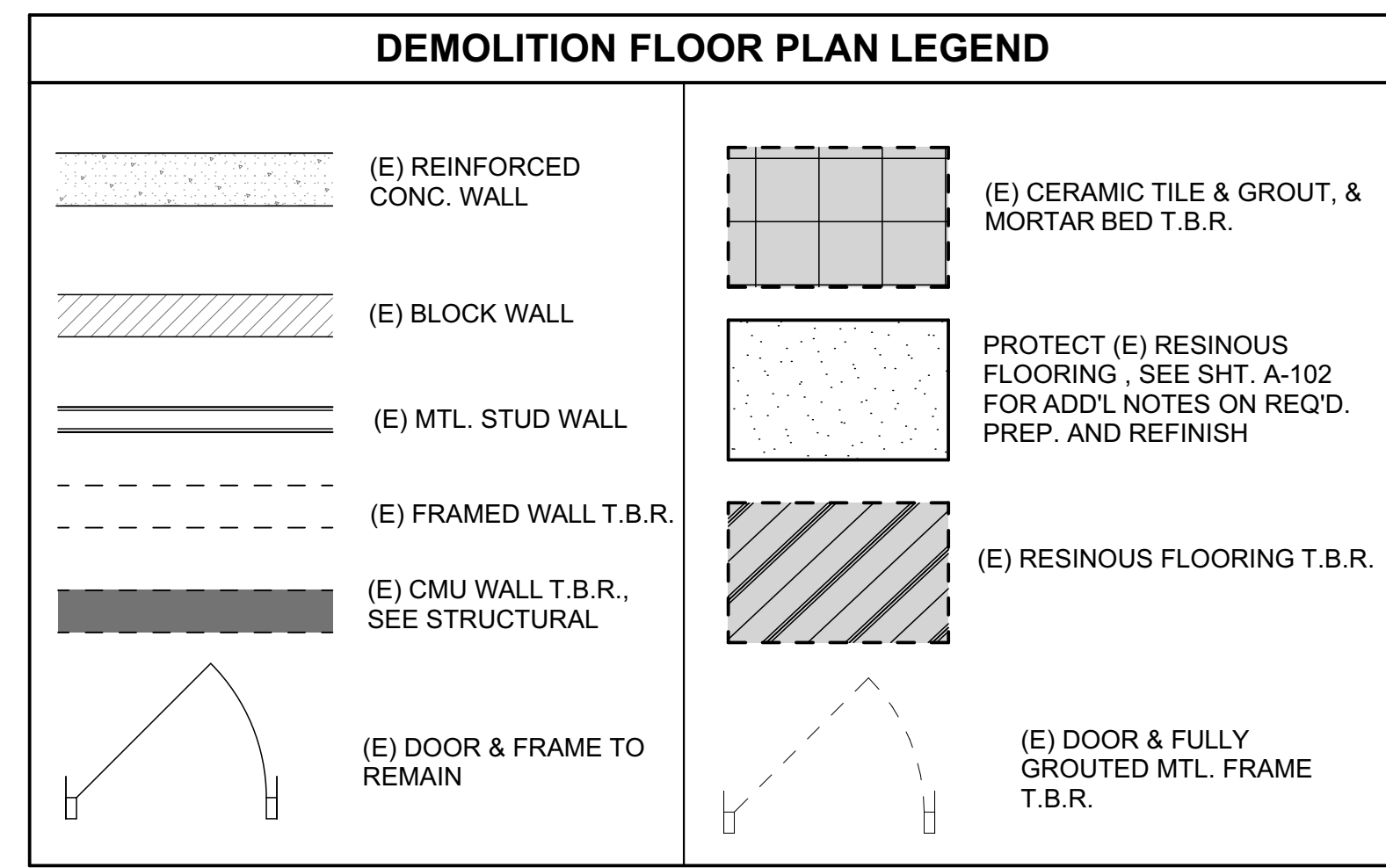

DEMOLITION FLOOR PLAN KEYNOTES

KEY	DESCRIPTION
01	SAWCUT REMOVE & DISPOSE OF (E) CERAMIC TILE, MORTAR BED & 4" STRUCTURAL SLAB & 3" BASE SLAB
02	REMOVE & DISPOSE OF (E) PLUMBING FIXTURES
03	REMOVE & DISPOSE OF (E) SHOWER FIXTURES & ALL ASSOCIATED PIPING
04	PROTECT (E) RESINOUS FLOORING & RESINOUS BASE THROUGHOUT CONSTRUCTION
05	(E) TOILET ACCESSORIES T.B.R., TYP.
06	PORTION OF (E) CMU WALL T.B.R., SEE STRUCTURAL
07	(E) DOOR & FULLY GROUTED HM FRAME T.B.R., PREP OPENING FOR CMU INFILL, SEE STRUCTURAL
08	(E) LOCKERS TO BE RELOCATED BY CONTRACTOR TO PROPERTY VAULT #6 DURING CONSTRUCTION. PRESERVE FOR RELOCATION BACK TO WOMEN'S LOCKER ROOM IN SAME LOCATION AFTER CONSTRUCTION COMPLETE.
09	(E) LOCKERS TO BE RELOCATED BY CONTRACTOR TO PROPERTY VAULT #6 DURING CONSTRUCTION. PRESERVE FOR RELOCATION BACK TO WOMEN'S LOCKER ROOM IN NEW LOCATION AT END OF CONSTRUCTION.

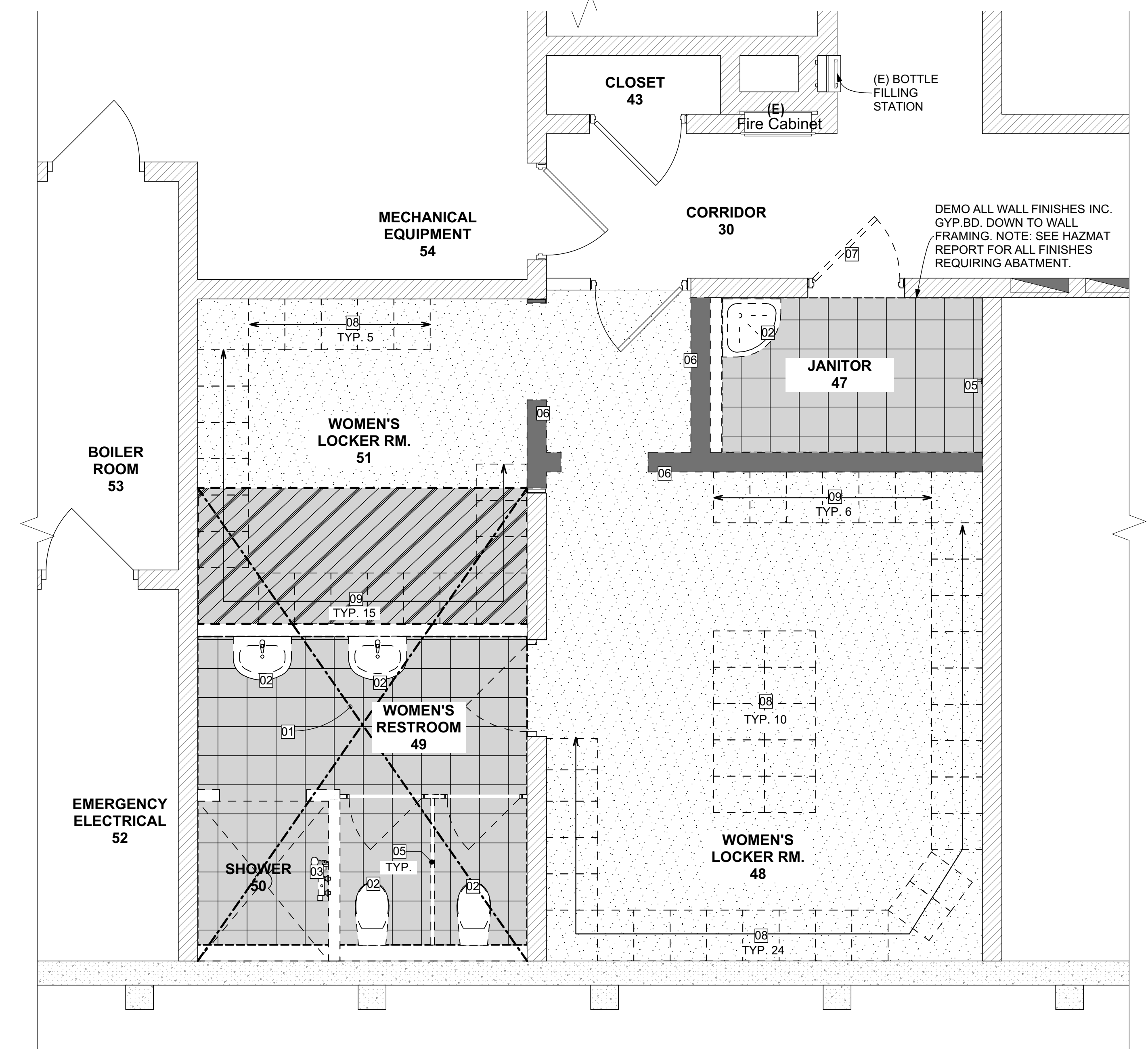

A1 ENLARGED DEMO FLOOR PLAN - WOMEN'S LOCKER / SHOWER / RESTROOM
SCALE: 3/8" = 1'-0"

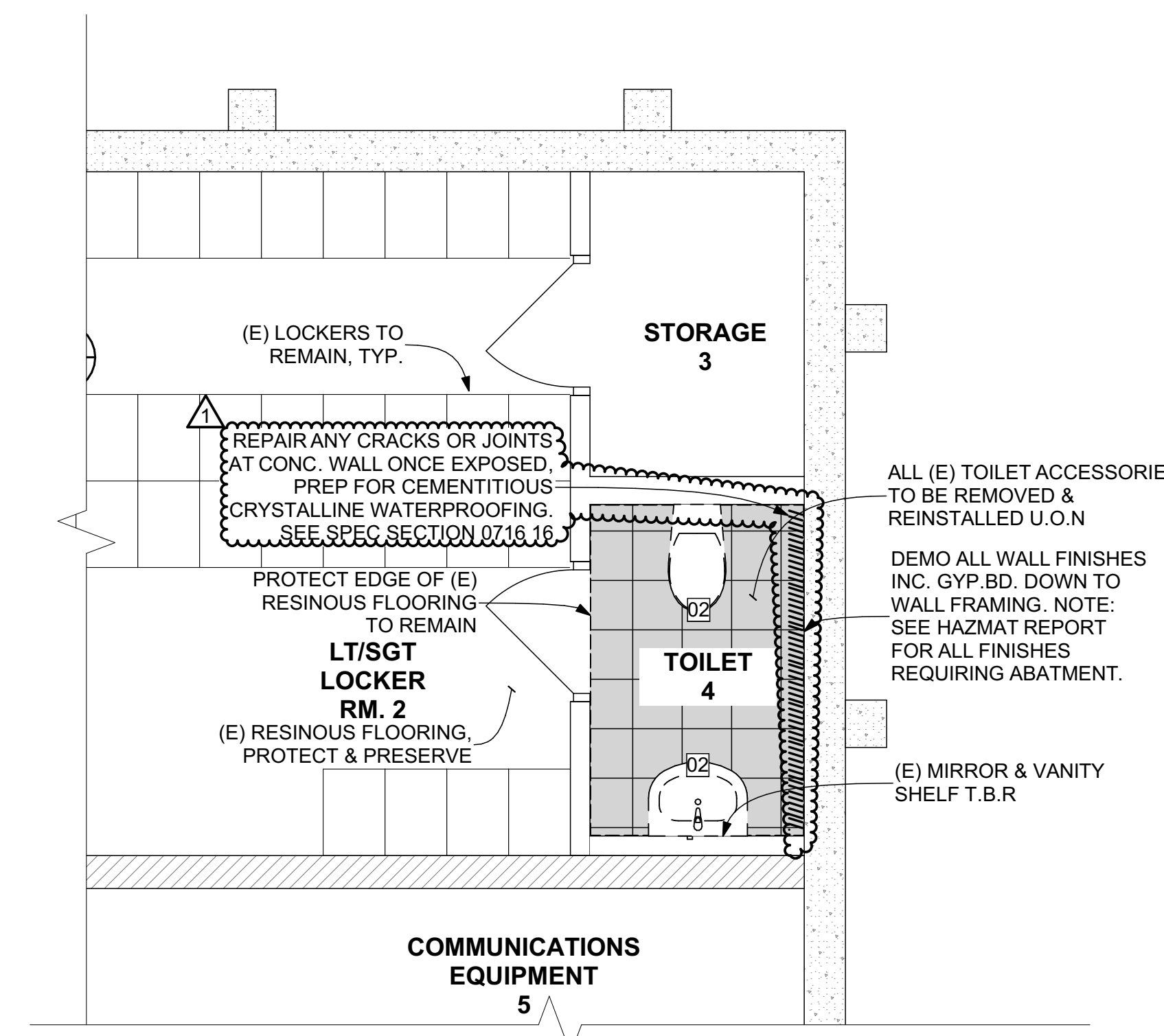

B2 ENLARGED DEMOLITION FLOOR PLAN - TOILET 4
SCALE: 3/8" = 1'-0"

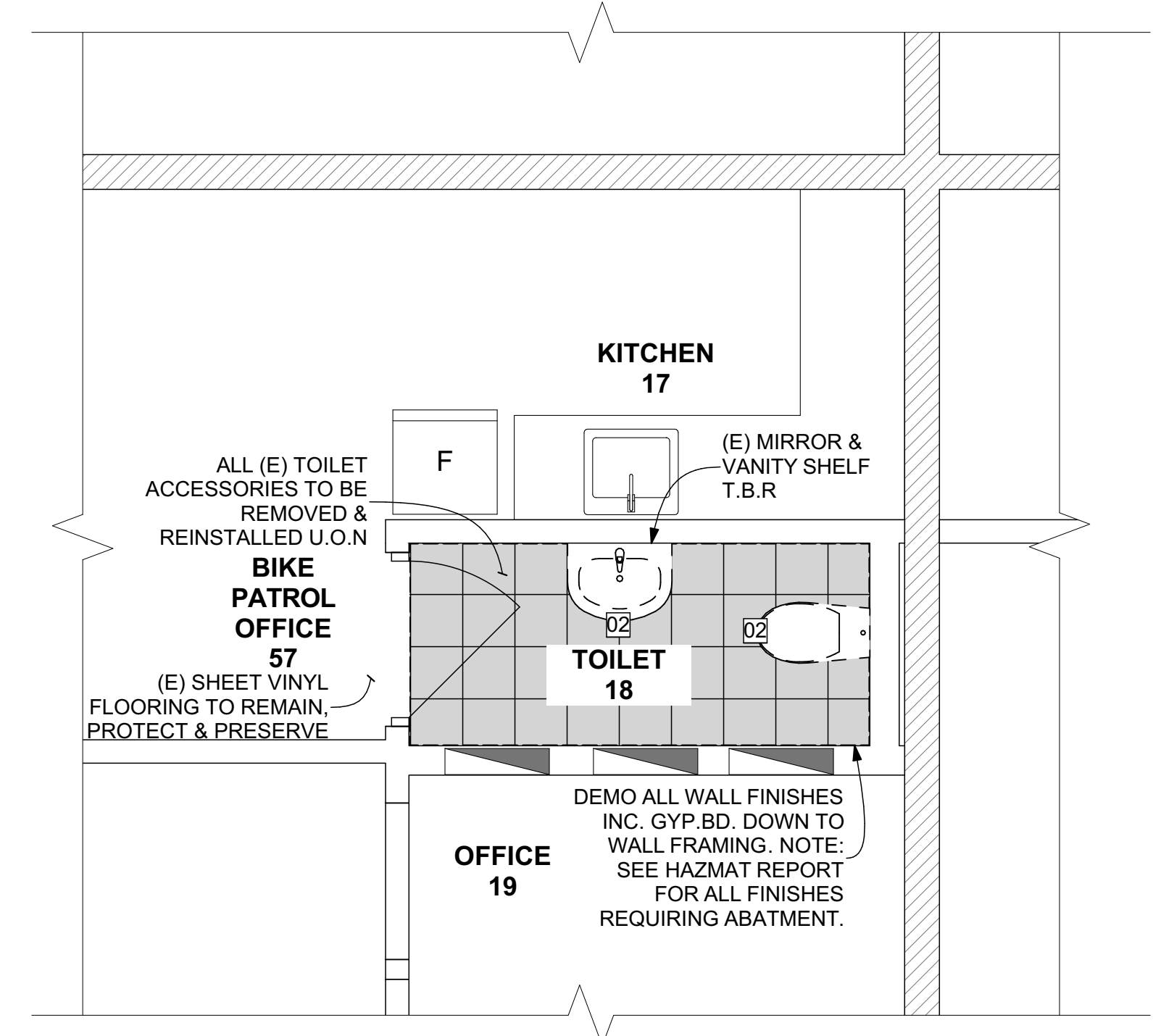

A2 ENLARGED DEMOLITION FLOOR PLAN - TOILET 18
SCALE: 3/8" = 1'-0"

Architect
indigo
HAMMOND+PLAYLE
ARCHITECTS, L.L.P.
art, architecture + ecology
909 FIFTH STREET, DAVIS, CA
530.750.0756 WWW.INDIGOARCH.COM

LICENSED ARCHITECT
ARTHUR BRUCE PRYDE
No. C 15459
Ren. 12-21-24
STATE OF CALIFORNIA

Consultant

Agency Approvals

City Approvals

Public Works Department
Approved by _____ Date _____
City Engineer, Stockton, CA

Issue: 100% CONSTRUCTION DOCUMENTS

No.	Date	Description
-	01/31/2022	Bid Set
△	02/24/22	LOC No. 1

Project
STOCKTON POLICE HQ WOMEN'S LOCKER RM REMODEL

Architect of Record: BP
Project Architect: CH
Drafted By: VPH
Checked By: PN

File Date: 01/20/22

Sheet Title
ENLARGED DEMO FLOOR PLANS

City Project Number
P015035-A

Sheet Number
A-101
Sheet 14 of 40

CAD FILE: BIMcloud Basic for ARCHICAD 26/Stockton/Stockton_PDHO Construction_Women Restroom_5-14-21_1/20/2022_12:02 PM

FLOOR PLAN LEGEND	
	(E) REINFORCED CONC. WALL
	(E) BLOCK WALL
	(E) MTL. STUD WALL
	CMU INFILL WALL, SEE STRUCTURAL
	MTL. STUD WALL, SEE WALL TYPE LEGEND & FINISH SCHEDULE FOR WALL FINISHES
	(E) DOOR & FRAME TO REMAIN.
	WALL TYPE INDICATOR, SEE SHT. A-511 FOR WALL DETAILS
	E02 NEW ELECTRIFIED PATROL LOCKER - ADA
	E03 (E) LOCKERS TO BE RELOCATED BACK FROM PROPERTY VAULT 46 TO SAME LOCATION PER PLAN - RETROFIT W/ NEW SURFACE RACEWAY THROUGH LOCKERS, SEE ELECT.
	E04 (E) LOCKERS TO BE RELOCATED BACK FROM PROPERTY VAULT 46 TO NEW LOCATION PER PLAN - RETROFIT W/ NEW SURFACE RACEWAY THROUGH LOCKERS, SEE ELECT.
	E05 (E) RE-USED LOCKERS, PROVIDED BY CITY TO BE INSTALLED IN WOMEN'S LOCKER ROOM - RETROFIT W/ NEW SURFACE RACEWAY THROUGH LOCKERS, SEE ELECT.

SIGNAGE KEYNOTES		
KEY	DESCRIPTION	DTL. REF.
A	IDENTIFICATION ROOM SIGN	D1 (G-104)
B	EXIT DOOR SIGN	C3 (G-104)
C	ADA SHOWER SIGN	B1 (G-104)
D	DOOR ROOM NAME SIGN	C1 (G-104)

FLOOR PLAN GENERAL NOTES

1) SEE SHT. A-401 FOR EQUIPMENT AND TOILET ACCESSORY SCHEDULES

ADA LOCKER CALCULATION

1) PER CBC 11B-222.1, 5% OF THE TOTAL OF LOCKERS PROVIDED ARE ADA COMPLIANT.

TOTAL LOCKERS = 75 X 5% = 3.75
 ADA LOCKERS PROVIDED = 4 ----> OK

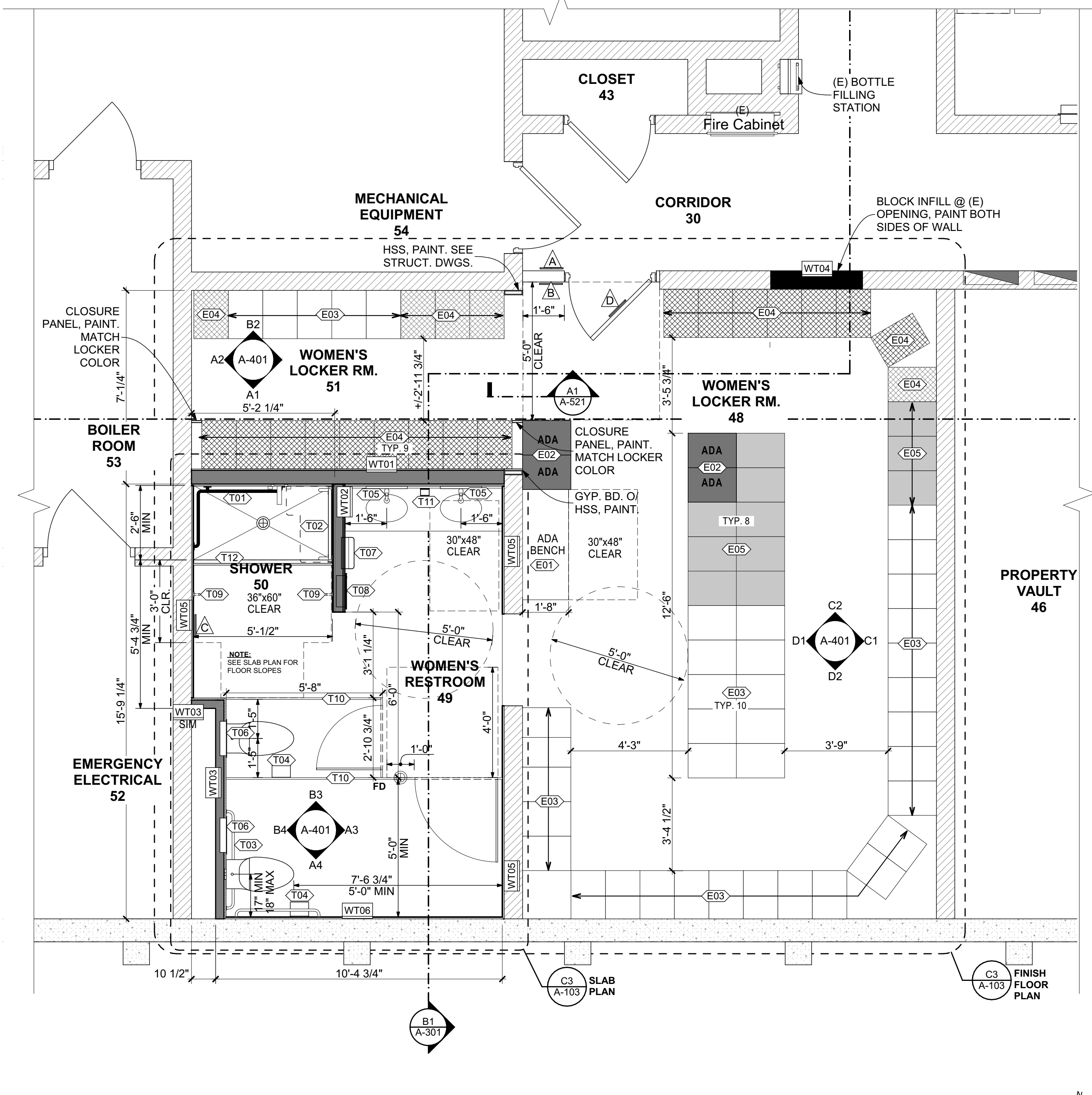

A1 ENLARGED NEW FLOOR PLAN - WOMEN'S LOCKER / SHOWER / RESTROOM
 SCALE: 3/8" = 1'-0"

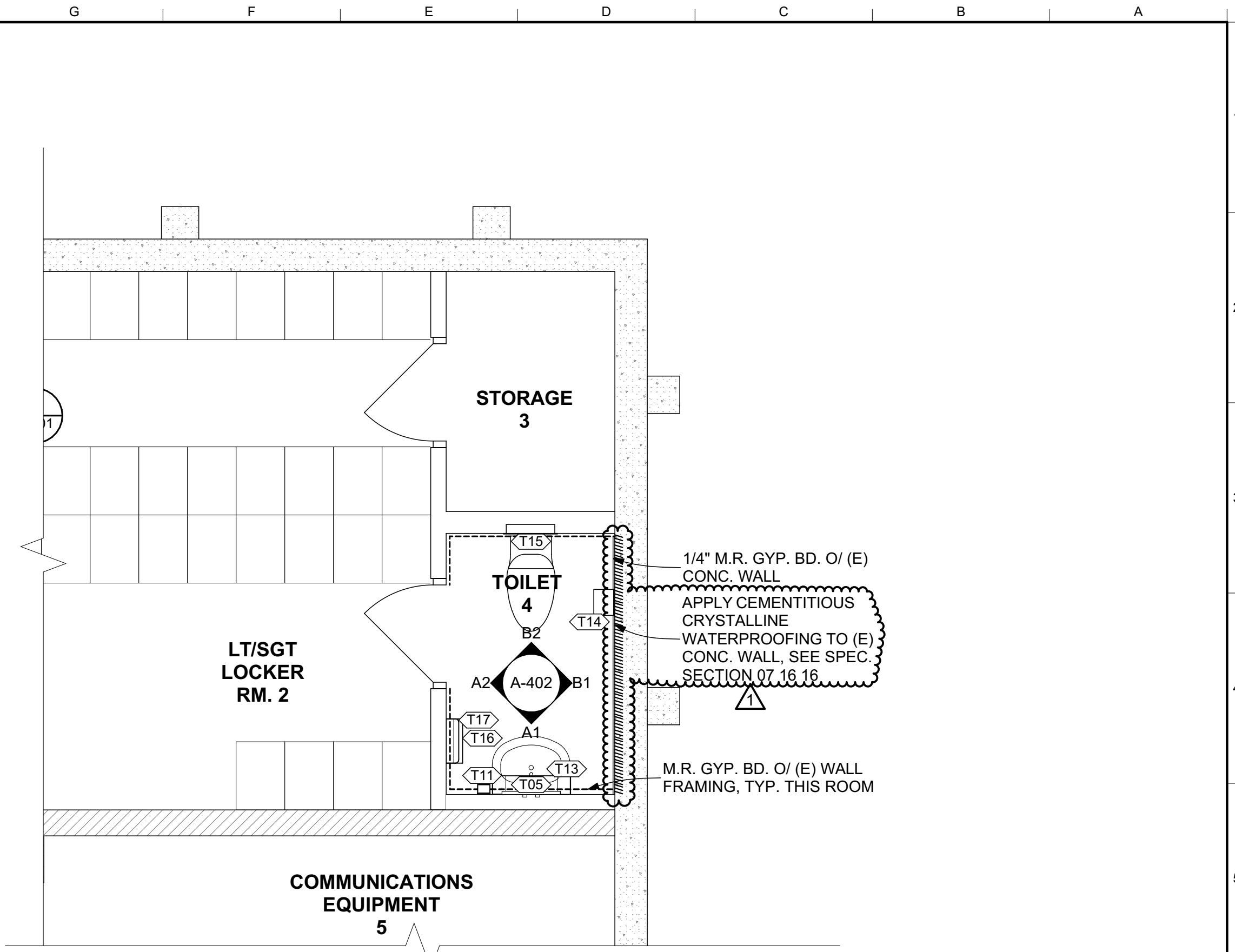

B2 ENLARGED NEW FLOOR PLAN - TOILET 4
 SCALE: 3/8" = 1'-0"

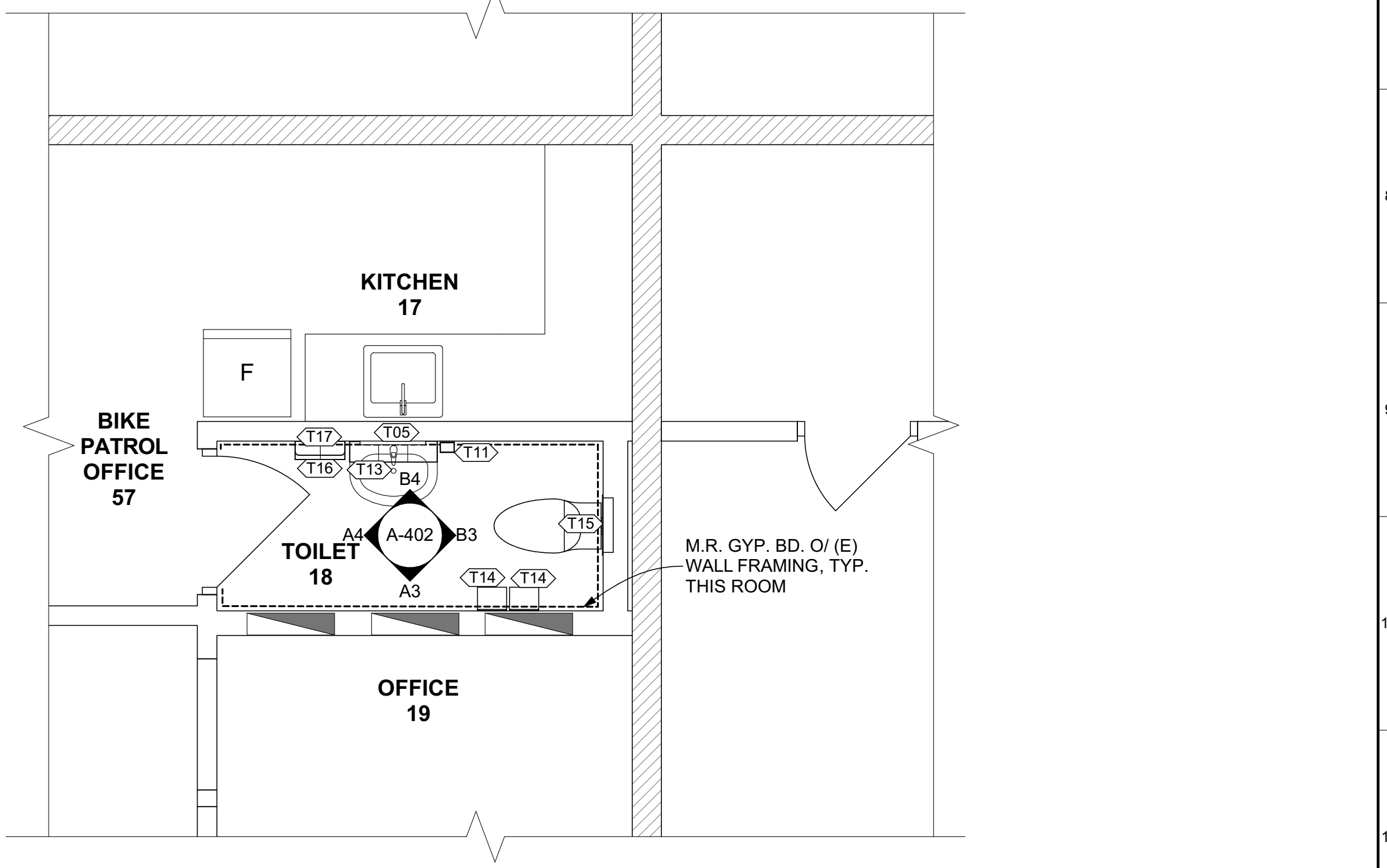

A2 ENLARGED NEW FLOOR PLAN - TOILET 18
 SCALE: 3/8" = 1'-0"

Architect

indigo
HAMMOND+PLAYLE
 ARCHITECTS, LLP
 art, architecture + ecology

909 FIFTH STREET, DAVIS, CA
 530.750.0756 WWW.INDIGOARCH.COM

Consultant

Agency Approvals

City Approvals

Public Works Department
 Approved by _____ Date _____
 City Engineer, Stockton, CA

Issue: 100% CONSTRUCTION DOCUMENTS

No.	Date	Description
1	01/31/2022	Bid Set
2	02/24/22	LOC No. 1

Project

STOCKTON POLICE HQ WOMEN'S LOCKER RM REMODEL

Architect of Record: BP
 Project Architect: CH
 Drafted By: VPH
 Checked By: PN

File Date: 01/20/22

Sheet Title

ENLARGED NEW FLOOR PLANS

City Project Number: P015035-A

Sheet Number

A-102
 Sheet 15 of 40

CAD FILE: BIMcloud Basic for ARCHICAD 26/Stockton/Stockton_PD/HQ Construction_Women Restroom_5-14-21_1/20/2022_12:02 PM